

SUZHOU XINFUJI ELECTROMECHANICAL CO., LTD

Add: Dade Industriial Zone,Wujiang Distict, Suzhou, Jiang
su Province
Tel :+8618605722020
E-Mail:xinfujielevator@126.com
Web: www.xinfujielevatorcom

Our company reserves all rights to change products, design description and parameter at any time without official notice.

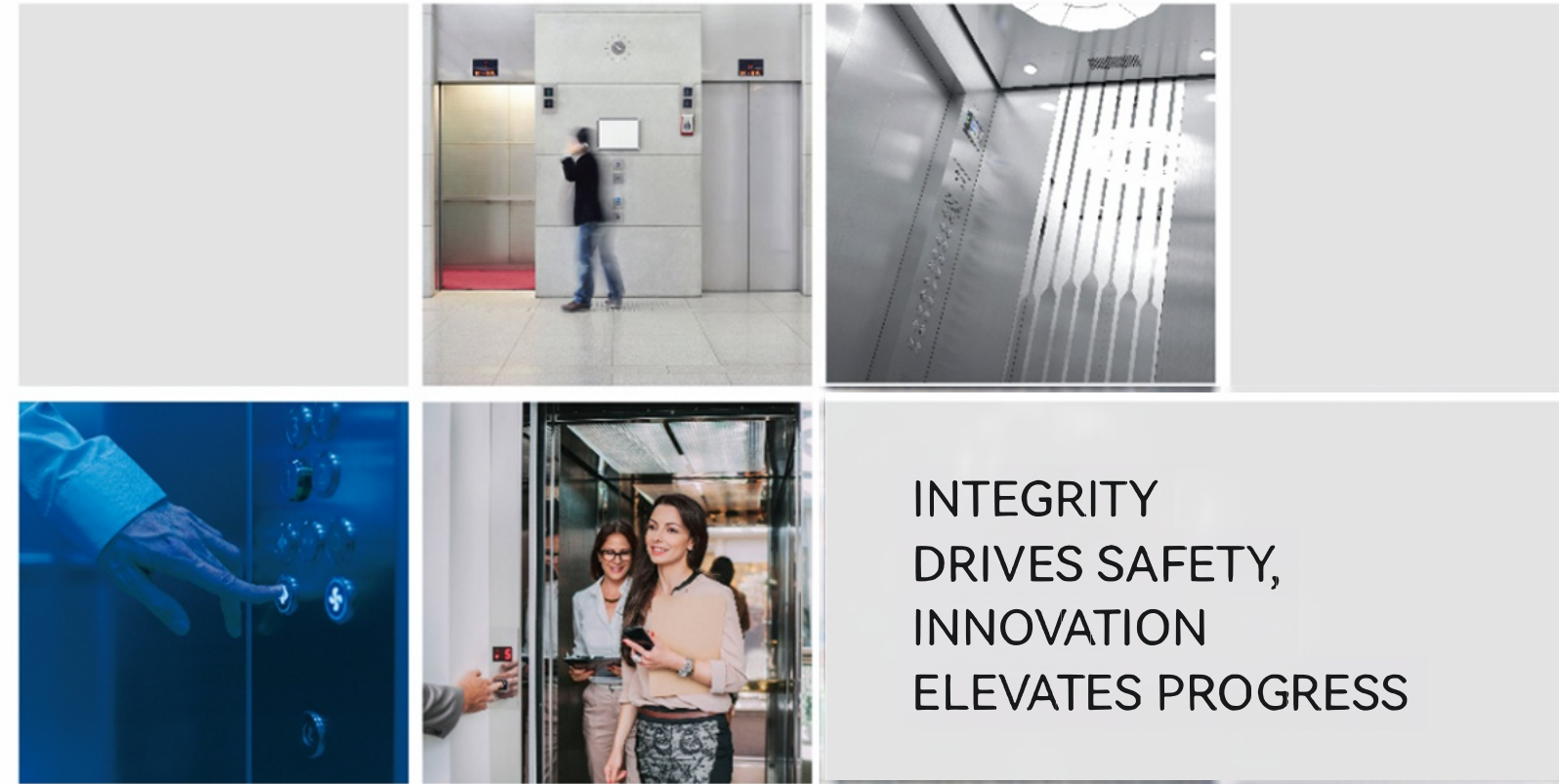

SUZHOU XINFUJI ELECTROMECHANICAL CO., LTD

FOR, PAKISTAN

MILLAT GROUP (Millat Engineering Solutions)
Add: Office No.1, Ground Floor, Millat Plaza, Street
No.2, Ghouri Town VIP, Islamabad-Pakistan.
Tel: 0336 6100044 | 0302 7770333
E-mail: info@millatgroup.pk
Web: www.millatgroup.pk





COMPANY PROFILE

Suzhou Xinfuj Electromechanical Co., Ltd. is a comprehensive elevator manufacturing service provider engaged in the R&D, production, sales, installation, maintenance, and modernization of elevators. Based in Suzhou, Xinfuji is one of China's leading elevator manufacturers.

Guided by a core philosophy of "all for safety reach," Xinfuj focuses on core technology and elevator safety, establishing an end-to-end service platform and a smart industrial ecosystem for the elevator industry. Xinfuji has built long-term strategic partnerships with major Chinese enterprises, including China State Construction, China Railway Group, China Communications Construction, and China Metallurgical Group. Recognized as a government-designated elevator supplier for multiple consecutive years, Xinfuji's products are exported to over 30 countries and regions, and it has become a highly regarded elevator brand in countries such as Russia, Australia, Mexico, Brazil, New Zealand, the UAE, India, Egypt, Iran, Bangladesh, and South Africa and Pakistan.



**CERTIFICATE OF
XINFUJI AUTHORIZED DISTRIBUTOR
FOR COMMODITY PRODUCTS AND SERVICES
IN PAKISTAN**

This certificate is proudly presented to

MILLAT GROUP (Millat Engineering Solutions)

**Address: Office No.1, Ground Floor, Millat Plaza, Street No.2,
Ghuri Town VIP, Khanapul, Islamabad.**

We proudly recognize your efforts and partnership in delivering quality solutions in mobility and services for our products, including elevators, escalators, related components and accessories, as well as maintenance and after-sales services.

Issued by:

Suzhou Xinfuji Electromechanical Co., Ltd.

Date: 12-12-2024

Valid Period: 12th Dec. 2024 — 12th Dec. 2034

Authorized Dealer in Pakistan

MillatGroup is a well-established and diversified business conglomerate in Pakistan, comprising multiple successful companies including MillatConsultants, MillatEngineeringSolutions. With a strong presence in the local market and an extensive network, Millat Group is committed to bringing world-class products and services to Pakistan.

As the Authorized Dealer of XINFUJI Elevator&Escalator in Pakistan, Millat Group will provide advanced, safe, and reliable vertical transportation Solutions, backed by XINFUJI 's 20 years of global expertise in elevator manufacturing. Together, XINFUJI and MillatGroup aim to set new benchmarks of quality, safety, and innovation in the Pakistan elevator and escalator industry.



Innovation · Quality · Profession

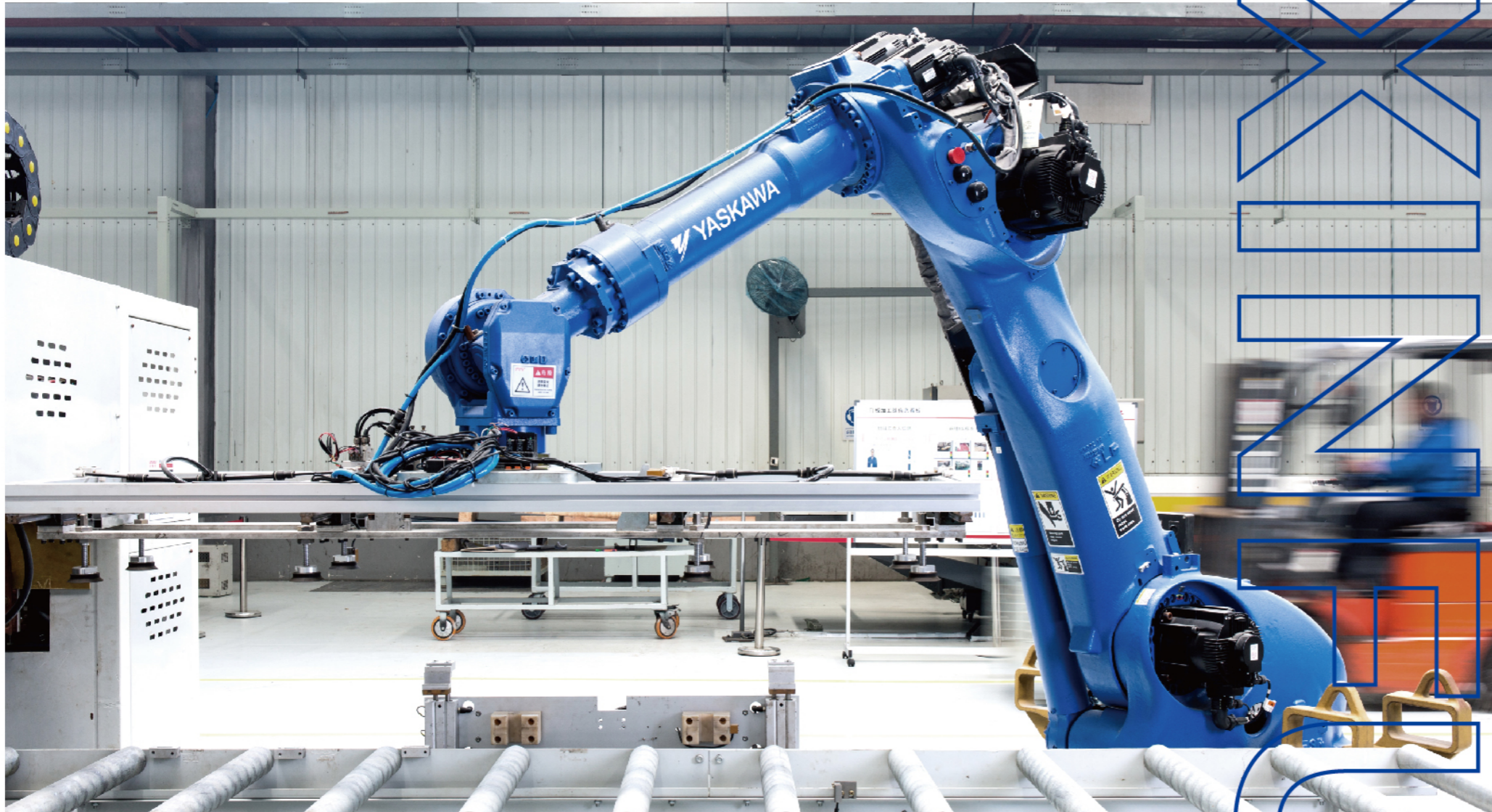

WARM TECHNOLOGY, INNOVATIVE HUMANE PROPERTIES

Suzhou Xinfuji, insisting on scientific innovation is only to realize a better life dream. Green energy feedback technology reduces energy consumption and reuses, perfectly interpreting the concept of green and low carbon.

XINFUJI

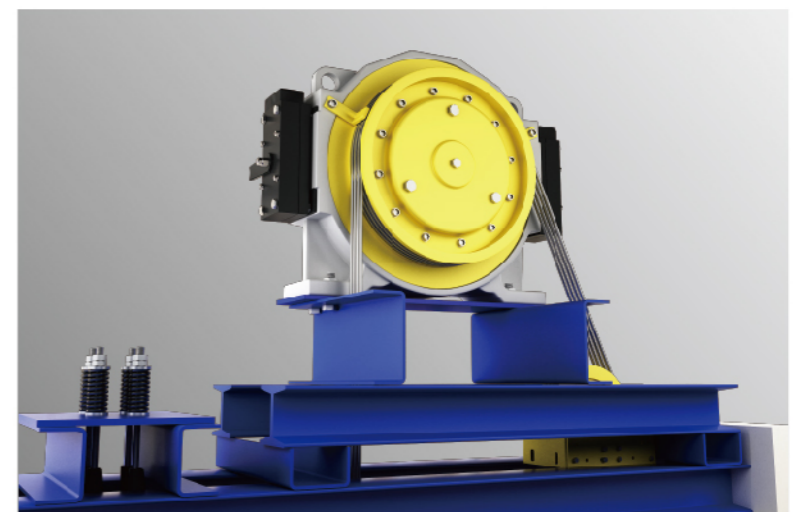

XINFUJI



ORGANIZATION

It establishes core competitive power with the enterprise. It matches with its business mode with effectively and orderly operation. It sets up an organizational framework with controllable risk.



SYSTEM

It establishes standard management system. It comprehensively fulfills automatic daily office. It introduces international standard management system. It sustainably enhances and perfects the systematic construction of modern business management.



TALENT

It sets up good achievement examination system. It greatly enhances average efficacy. It keeps increasing values of high and medium administrators. It fosters a group of excellent management team.

GIVE FULL SCOPE TO THE TALENTS BACKBONE STRENGTH

From management to production, from research and development to sales. Each product is immersed in the dedication and hard work of every Suzhou Xinfuji employee, and Suzhou Xinfuji strictly produces in accordance with national standards. Rigorous manufacturing process and equipment process ensure the safety and reliability of quality from the source.



Innovation · Quality · Profession

XINFUJI

EFFICIENT & intellectual EVERLASTING CLASSICAL

Suzhou Xinfuji is dedicated to continuous innovation and excellence. As we face new market dynamics, our commitment to progress remains steadfast. With a forward-thinking approach and a focus on quality, we strive to set new standards in the elevator industry, reaching greater heights and delivering exceptional value to our clients.



XINFUJI

INTEGRATED ELEVATOR SOLUTION SERVICE PROVIDER

PASSENGER ELEVATOR car decoration



FJ-K001 Standard

Ceiling: Hairline stainless steel, acrylic board, LED energy saving lamp

Car wall: Hairline stainless steel, rear wall mirror etching

Floor: Marble floor

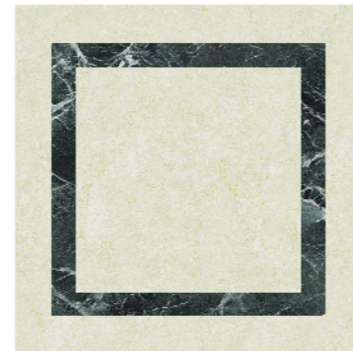

FJ-F001

Floor: PVC



FJ-M001

Door: Hairline stainless steel



FJ-K002 ◀

Car top: Mirror stainless steel, acrylic lighting, downlight
 Car wall: Hairline stainless steel, mirror etching stainless steel
 Handrail: Stainless steel flat handrails
 Floor: PVC

FJ-K003 ▶

Car top: Hairline stainless steel, acrylic lighting
 Car wall: Hairline stainless steel
 Handrail: None
 Floor: PVC



PASSENGER ELEVATOR car decoration



FJ-K004 △
 Car top: Mirror stainless steel, tube light
 Car wall: Mirror stainless steel, hairline stainless steel
 Handrail: None
 Floor: PVC



FJ-K005 △
 Car top: Mirror stainless steel, acrylic lighting, tube light
 Car wall: Mirror etched stainless steel, hairline stainless steel
 Handrail: Stainless steel flat armrest
 Floor: PVC



FJ-K008 △
 Car top: Mirror stainless steel, acrylic lighting, tube light
 Car wall: Mirror etched stainless steel
 Handrail: Stainless steel single tube handrail
 Floor: PVC

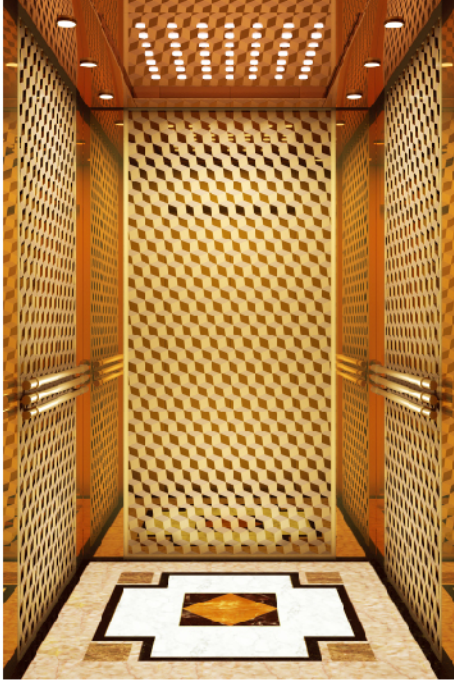

FJ-K009 △
 Car top: Champagne gold border, acrylic transparent board
 Car wall: Champagne gold, mirror, etching
 Handrail: Champagne gold and solid wood combination
 Floor: PVC



FJ-K006 △
 Car top: Hairline stainless steel, tube light
 Car wall: Mirror etched stainless steel
 Handrail: Stainless steel single tube handrail
 Floor: PVC

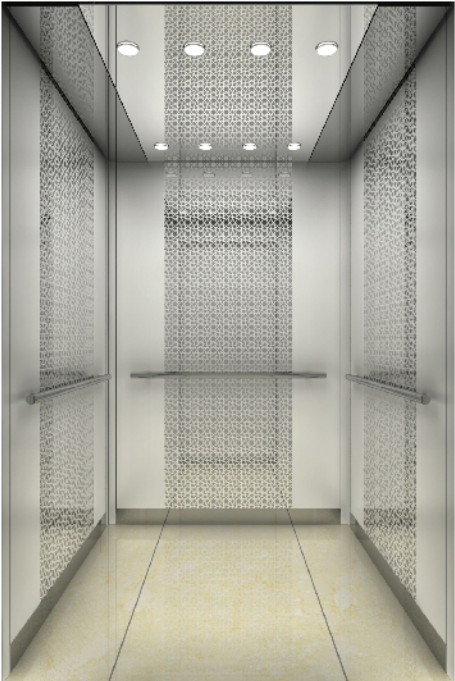

FJ-K007 △
 Car top: Mirror stainless steel, hairline stainless steel, tube lamp
 Car wall: Mirror etched stainless steel, hairline stainless steel
 Handrail: Stainless steel single tube handrail
 Floor: PVC



FJ-K010 △
 Car top: Titanium gold mirror stainless steel with LED lighting decoration panel
 Car wall: Titanium gold hairless stainless steel, titanium gold mirror etching stainless steel
 Handrail: Titanium gold stainless steel round handrail
 Floor: PVC



FJ-K011 △
 Car top: Mirror stainless steel frame, acrylic light decoration, LED light
 Car wall: Titanium gold mirror etching stainless steel
 Handrail: Titanium gold hairline stainless steel
 Floor: Titanium gold mirror stainless steel PVC

PASSENGER ELEVATOR car decoration



FJ-K012 △

Car top: Titanium mirror stainless steel, acrylic lighting, tube lamp
 Car wall: Titanium, mirror finish, etched
 Handrail: Titanium stainless steel single tube handrail
 Floor: PVC



FJ-K013 △

Car top: Titanium mirror stainless steel, tube lamp
 Car wall: Titanium gold, mirror finish, etching, titanium gold stripe
 Handrail: Titanium stainless steel single tube handrail
 Floor: PVC



FJ-K016 △

Car top: Mirror stainless steel, white organic panel
 Car wall: Stainless steel mirror, hairline, etched pattern
 Handrail: None
 Floor: PVC



FJ-K017 △

Car top: Japanese gold mirror stainless steel, ambient light
 Car wall: Khaki stainless steel, dark green stainless steel design, ambient lighting
 Handrail: Japanese gold styling design
 Floor: Marble

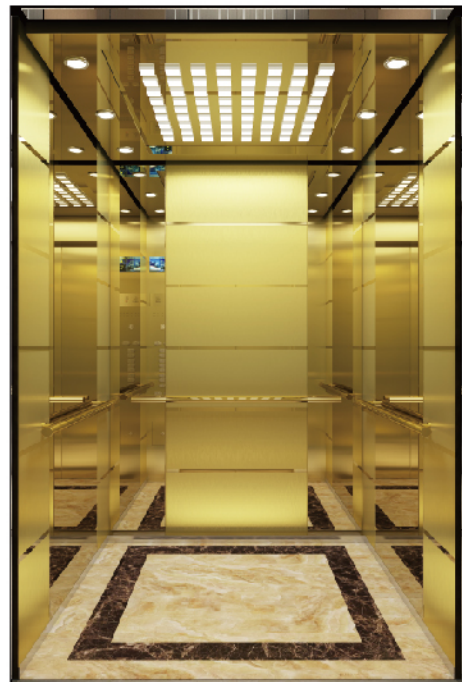

FJ-K014 △

Car top: Titanium mirror stainless steel, acrylic lighting, tube lamp
 Car wall: Titanium, mirror finish, etched
 Handrail: Titanium stainless steel single tube handrail
 Floor: PVC



FJ-K015 △

Car top: Bronze mirror stainless steel, acrylic lighting, tube light
 Car wall: Bronze, mirror finish, etched
 Handrail: Copper stainless steel single tube handrail
 Floor: PVC



FJ-K018 △

Car top: White latex paint, Crystal lamp
 Black titanium mirror decorative strip
 Car wall: Black titanium hairline stainless steel, Leather splicing
 Handrail: Imitation leather handrail
 Floor: PVC



FJ-K019 △

Car top: Painted steel plate, Champagne gold post frame LED, Hidden lamp belt
 Car wall: Marble, Black titanium mirror etched stainless steel
 Handrail: Black titanium hair pattern handrail
 Floor: PVC

PASSENGER ELEVATOR car decoration



FJ-K020 △

Car top: Wooden veneer, tube lamp, light strip
 Car wall: Cloud stone patterned steel plate, oak patterned steel plate, black titanium gold patterned stainless steel, light strip
 Handrail: None
 Floor: Goodburg limestone slab



FJ-K021 △

Car top: Morandi white stainless steel, mirror decorated LED light
 Car wall: Morandi white stainless steel, mirror decorative design
 Handrail: Black titanium stainless steel flat armrest
 Floor: Black and white marble splicing

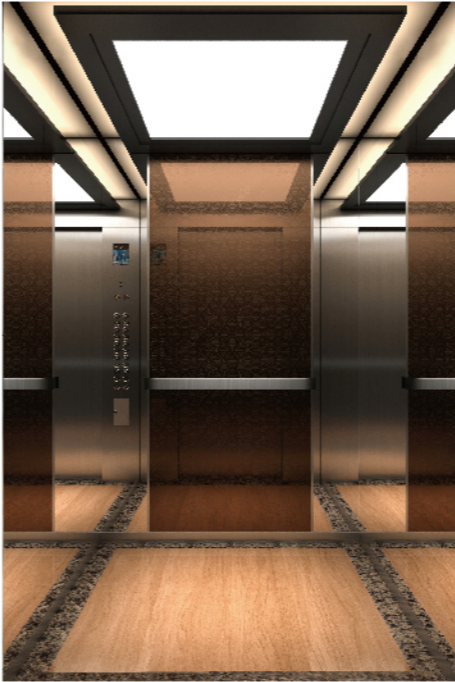

FJ-K024 △

Car top: Hairline stainless steel, black titanium hairline stainless steel, acrylic lighting
 Car wall: Antique copper mirror etched stainless steel, mirror stainless steel
 Handrail: Stainless steel flat armrest
 Floor: PVC



FJ-K025 △

Car top: Bronze colored gold foil textured stainless steel, lighting fixtures
 Car wall: Bronze colored gold foil texture stainless steel, rock board, light strip
 Handrail: None
 Floor: PVC

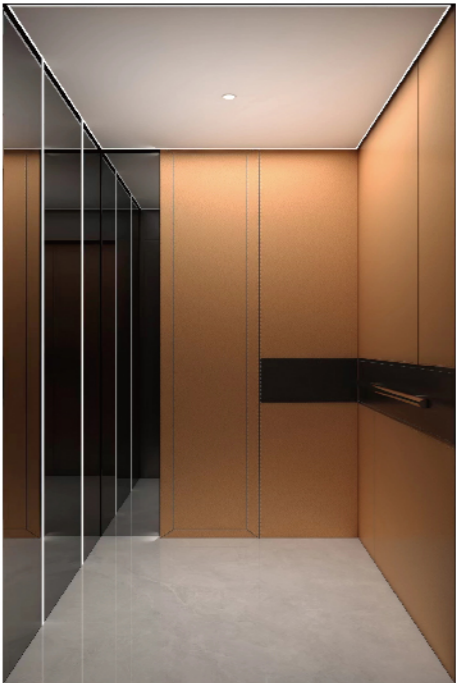

FJ-K022 △

Car top: Matte white honeycomb panel, tube light, light strip
 Car wall: Car mounted microfiber leather, light strip, rose gold mirror stainless steel, Black titanium mirror stainless steel, black titanium gold embossed stainless steel, light strip
 Handrail: Integrated leather armrest
 Floor: Goodburg limestone slab



FJ-K023 △

Car top: Mirror stainless steel, acrylic lighting, tube light
 Car wall: Bronze patterned stainless steel, stainless steel mirror finish, etched
 Handrail: Titanium stainless steel single tube handrail
 Floor: PVC

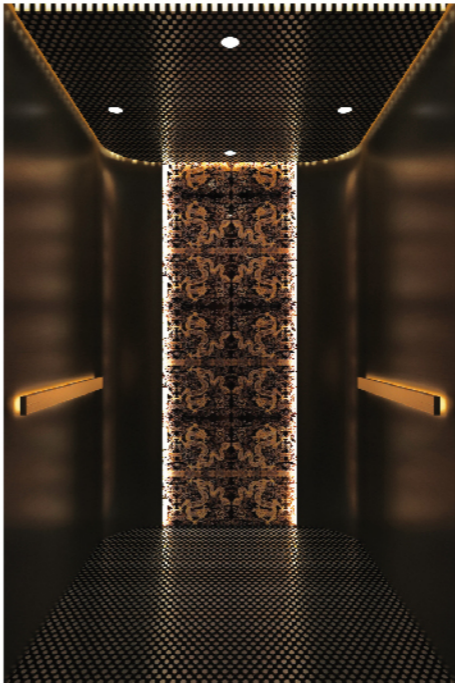

FJ-K026 △

Car top: Bronze patterned stainless steel, tube light
 Car wall: Bronze patterned stainless steel, artistic woven fabric, light strip
 Handrail: Titanium gold patterned stainless steel, light strip
 Floor: Bronze Hairline Stainless Steel



FJ-K027 △

Car top: Bronze colored gold foil textured stainless steel, light strip, tube light
 Car wall: Bronze colored gold foil textured stainless steel, light strip
 Handrail: Copper stainless steel square tube handrail, light strip
 Floor: Bronze Hairline Stainless Steel Pattern

OBSERVATION ELEVATOR car decoration



FJ-K028 △

Upper / lower cover: Titanium gold etching, steel plate baked enamel
 Observation wall : Safety laminated glass
 Decoration top: Steel plate baked enamel, acrylic lighting decoration
 Car wal: Titanium gold mirror etched stainless steel
 Handrail: Titanium gold double-tube handrail
 Floor: PVC



FJ-K029 △

Upper/ lower cover: Half-round acrylic crown, metal outer cover, painted steel plate skirting
 Observation wall: 3PCS of safety laminated glass
 Decoration top: Art modeling lamp,down lamp
 Car wal: Hairline stainless steel
 Handrail: Stainless steel double-tube
 Floor: PVC



FJ-K030 △

Upper/lower cover:Steel plate baked enamel, acrylic lighting decoration
 Observation wall: Safety laminated glass
 Decoration top: Mirror stainless steelacrylic arch top panel,downmp
 Car wal: Hairline stainless steel panel
 Handrail: φ38 stainless steel tube
 Floor: PVC



FJ-K031 △

Upper/lower cover: Steel plate baked enamel , acrylic lighting decoration
 Observation wall: Safety laminated glass
 Decoration top: Multi-ply reflection of lightpanel is supplemented with four-side waistlight-emitting holes ,lighting design oforganic light pole , soft 3D light
 Car wal: Laminated glass
 Handrail: 38 stainless steel tube
 Floor: PVC

OBSERVATION ELEVATOR car decoration



FJ-K032 △

Car top: Star dome, LED light strip
 Car wall: Sprayed steel plate/stainless steel, sightseeing glass
 Handrail: None
 Floor: PVC

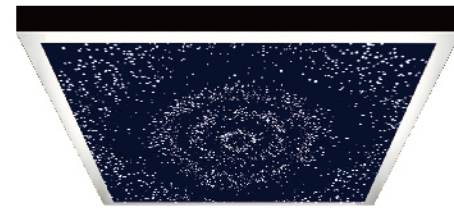

FJ-D001
 Star dome, LED light strip

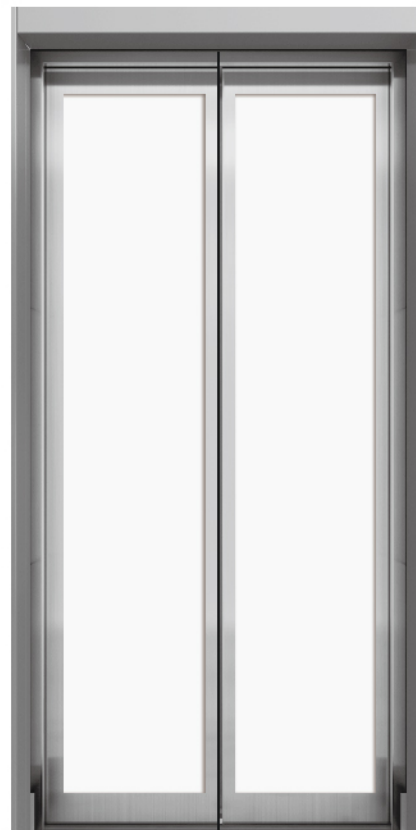

FJ-M002 △

Sprayed steel plate/stainless steel, sightseeing glass



FJ-K033 ◀

Car top: Rose gold mirror stainless steel, LED light
 Car wall: Rose gold hairline stainless steel, safety laminated glass
 Handrail: None
 Floor: PVC

FJ-K034 ▶

Car top: Champagne gold mirror stainless steel,
 champagne gold hairline stainless steel, LED light strip
 Car wall: Champagne gold stainless steel frame, safety laminated glass
 Handrail: None
 Floor: PVC





FREIGHT ELEVATOR car decoration

BED ELEVATOR car decoration



FJ-Z001 ◀

Ceiling: Paint steel
 Car wall/Car Door: Paint steel
 Illumination: Energy-saving light
 Door opening mode: Side opening
 Floor: Checkered plate

FJ-Z002 ▶

Ceiling: Hairline stainless steel
 Car wall/Car Door: Hairline stainless steel
 Illumination: Energy-saving light
 Door opening mode: Center-opening & double folded type
 Floor: Checkered plate



FJ-B001 △

Car top: Paint steel, LED lighting
 Car wall: Hairline stainless steel
 Handrail: Double flat stainless steel
 Floor: PVC



FJ-B002 △

Car top: Paint steel, LED lighting, downlight
 Car wall: Hairline stainless steel
 Handrail: Double flat stainless steel
 Floor: PVC

OPERATION PANDEL SERIES



CALL BOX



Hall lantern series



Outside the hall monitor



CEILING SERIES



FJ-D002 ◀

Mirror stainless steel , acrylic

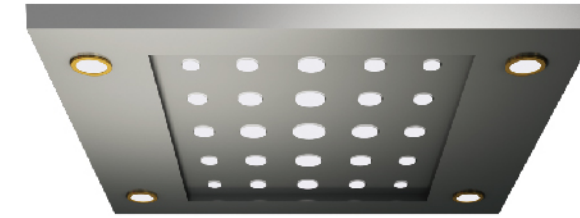

FJ-D007 ◀

Soft lighting design of multilayer reflector with golden downlight



FJ-D008 ▶

Mirror stainless steel , acrylic

FJ-D003 ▶

White arch light-emitting panel , stainless steel mirror flame ,strip light decoration

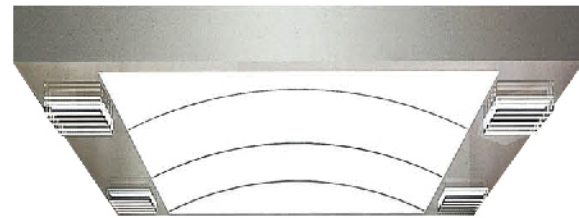

FJ-D009 ◀

Mirror stainless steel , acrylic



FJ-D004 ◀

Mirror stainless steel , acrylic

FJ-D010 ▶

The cylindrical hollow transparent lamp, soft lighting design with arched white transparent plate



FJ-D005 ▶

Stainless steel side frame , soft lighting design of arch white light-emitting panel



FJ-D011 ◀

Hairline stainless steel frame , white transparent board, downlight

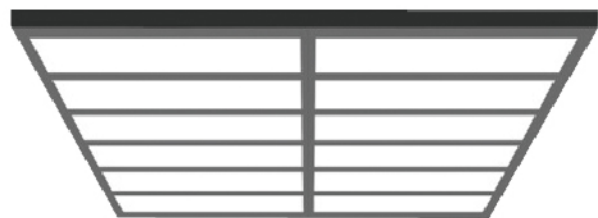

FJ-D006 ◀

Stainless steel side frame , soft lighting design of arch white light-emitting panel

FJ-D012 ▶

The middle image roof, both sides for soft illumination design of stainless steel floor with downlight

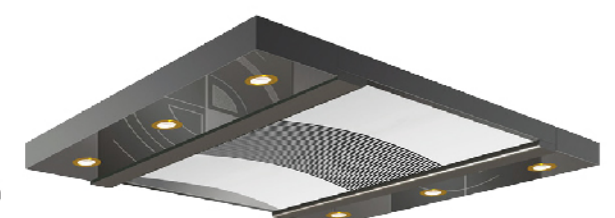



LANDING DOOR SERIES



FJ-M003



FJ-M004



FJ-M005



FJ-M009



FJ-M010



FJ-M011



FJ-M006



FJ-M007



FJ-M008



FJ-M012



FJ-M013



FJ-M014

HANDRAIL SERIES



HANDRAIL SERIES

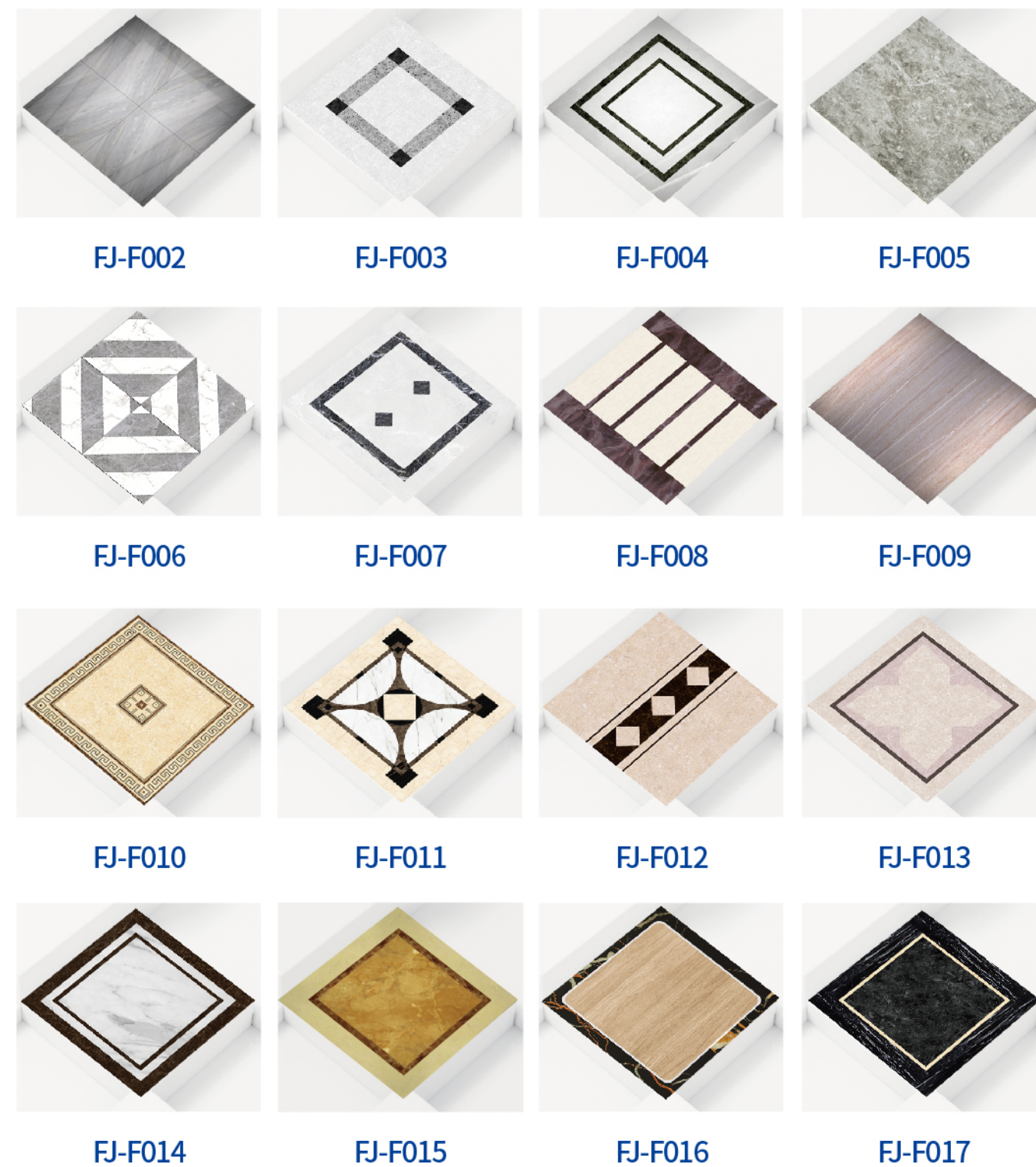

ESCALATOR

XINFUJI escalator applies the advanced Swiss technology, design concept for manufacture.

It grants you to appreciate the outstanding charm and deluxe manner of modern buildings by fine and exquisite structure, consummate elevator path, delicate belt, deluxe and attractive outline. It provides the passengers with a bright, comfortable, brand-new feeling.

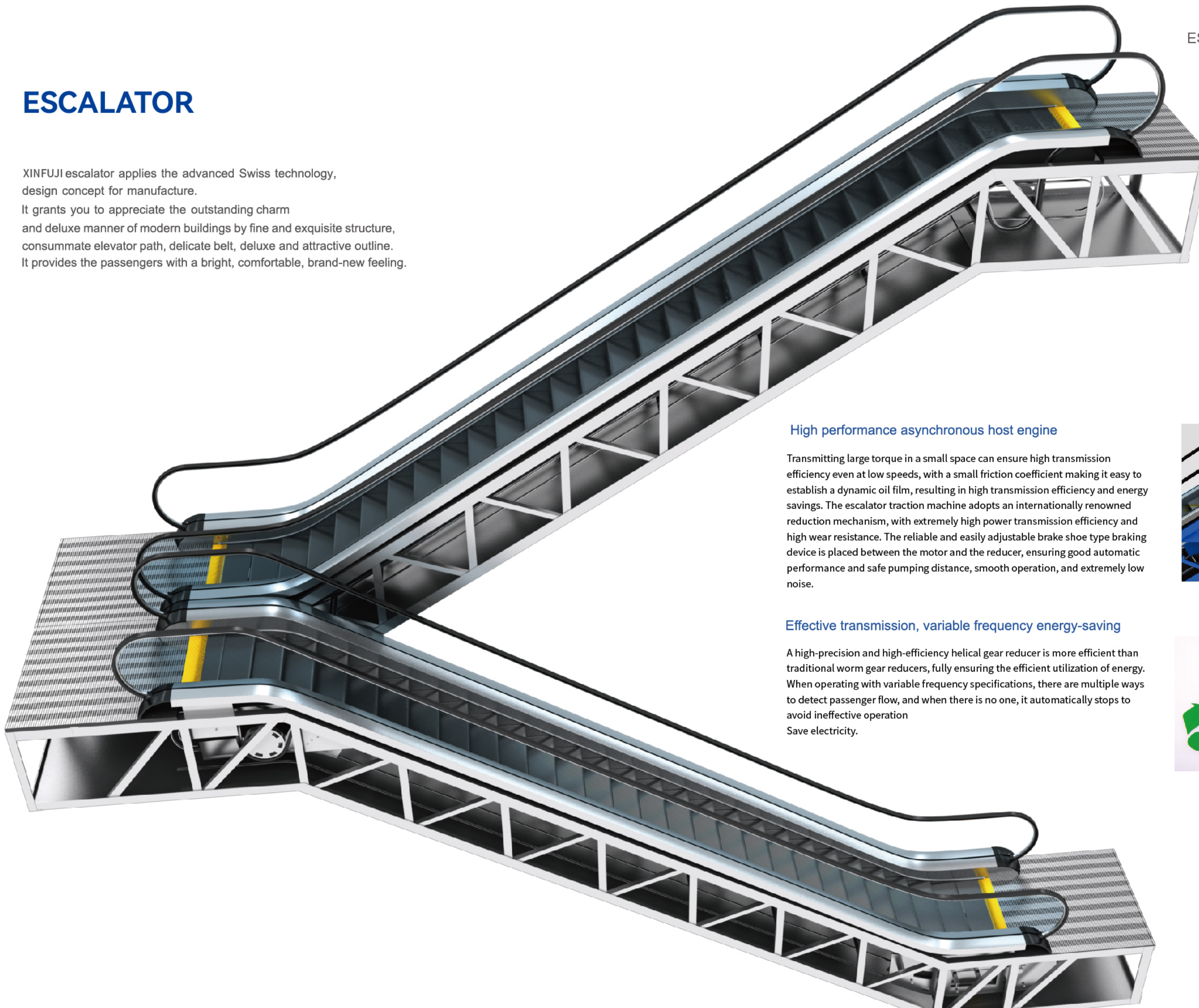

High performance asynchronous host engine

Transmitting large torque in a small space can ensure high transmission efficiency even at low speeds, with a small friction coefficient making it easy to establish a dynamic oil film, resulting in high transmission efficiency and energy savings. The escalator traction machine adopts an internationally renowned reduction mechanism, with extremely high power transmission efficiency and high wear resistance. The reliable and easily adjustable brake shoe type braking device is placed between the motor and the reducer, ensuring good automatic performance and safe pumping distance, smooth operation, and extremely low noise.

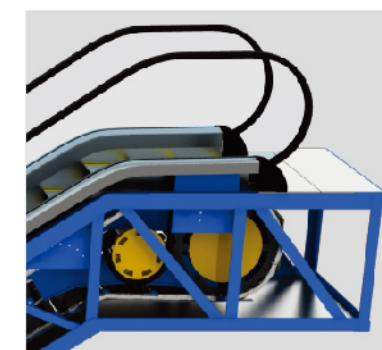

Effective transmission, variable frequency energy-saving

A high-precision and high-efficiency helical gear reducer is more efficient than traditional worm gear reducers, fully ensuring the efficient utilization of energy. When operating with variable frequency specifications, there are multiple ways to detect passenger flow, and when there is no one, it automatically stops to avoid ineffective operation. Save electricity.



MOVING WALK

XINFUJI moving walk satisfies the transport requirement of large passenger flow in public traffic and transport areas such as large-size supermarket, airport, exhibition center, transport hub etc. It meets long-distance walk. People feel as easily as walking on firm earth while carrying luggage cart, baby's cart, the vehicle for the disabled in moving walk. It is greatly convenient for the people's outing and shopping.

Compact structure

The fish belly beam type short pedal greatly reduces the space span and saves valuable building space for customers.

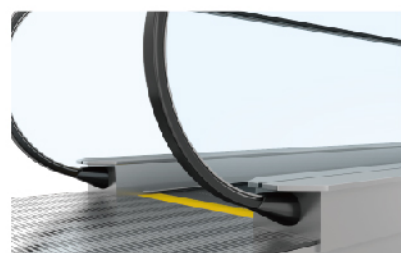

Energy-saving running mode

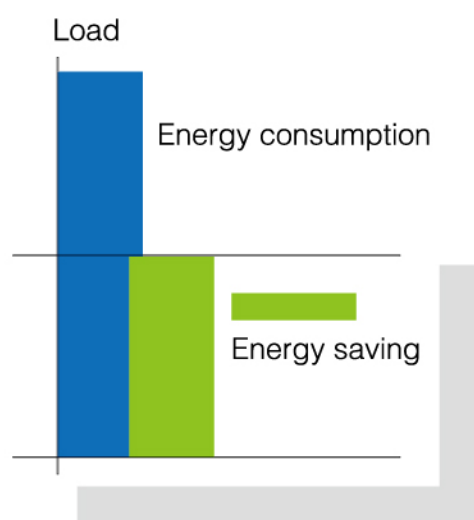

SMALL MACHINE ROOM PASSENGER ELEVATOR CONSTRUCTION SKETCH

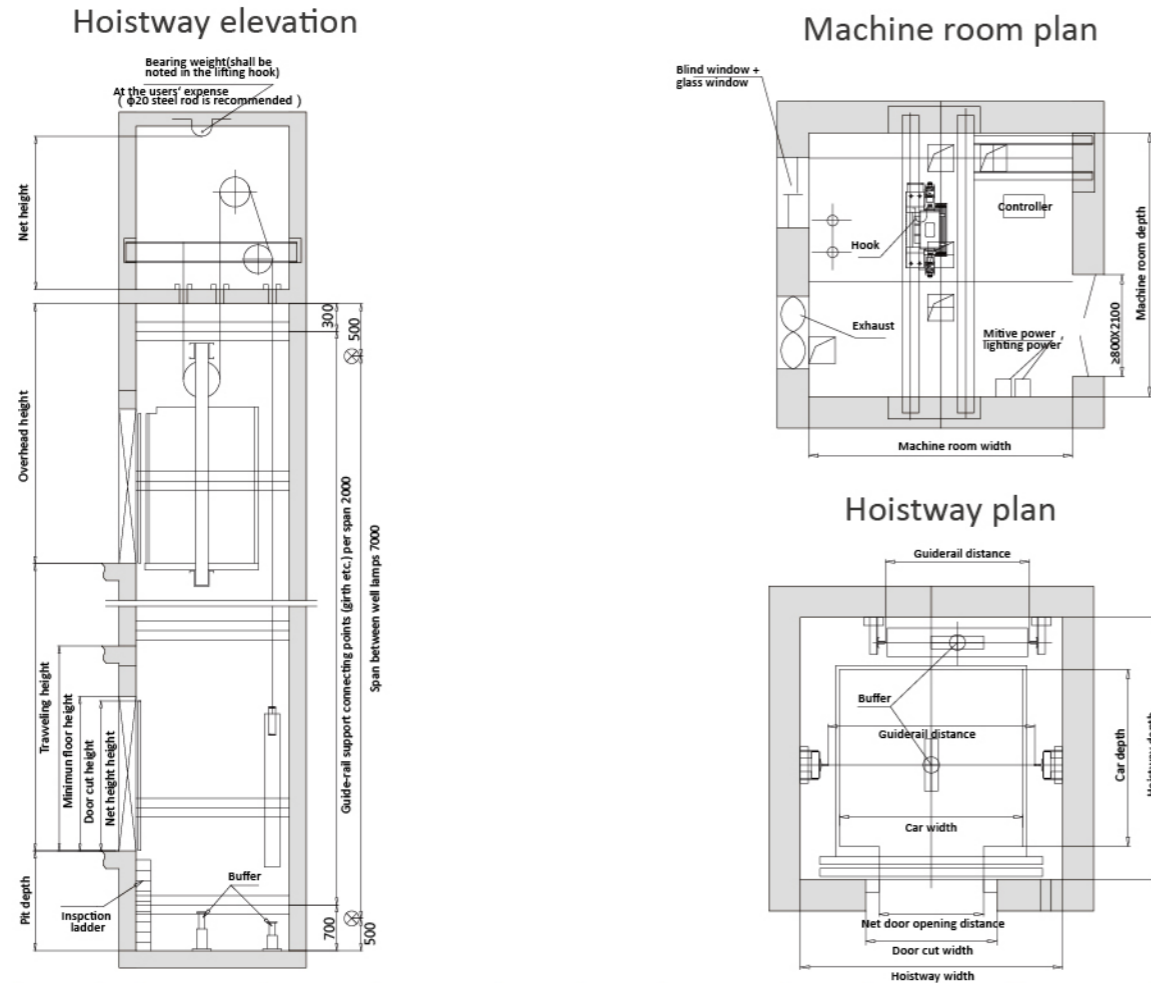

Capacity kg	Speed m/s	Door size DW×DH(mm)	Cabin size CW×CD(mm)	Shaft size HW×HD(mm)	Top floor height OH(mm)	Pit depth PD(mm)	Machine room size RW×RH(mm)	Machine room height RH(mm)	Maximum Layer Station Number	Maximum lifting height TH(m)	Person
450	1.0	800×2100	1200×1000	1800×1700	≥4500	≥1500	1800×1700	≥2500	≤16	≤55	6
	1.5				≥4600	≥1600			≤24	≤85	
	1.75				≥4700	≥1700			≤32	≤100	
630	1.0	800×2100	1400×1100	1950×1800	≥4500	≥1500	1950×1800	≥2500	≤16	≤55	8
	1.5				≥4600	≥1600			≤24	≤85	
	1.75				≥4700	≥1700			≤32	≤100	
800	2.0	800×2100	1400×1350	2000×1850	≥4800	≥1800	2000×1850	≥2500	≤40	≤110	10
	1.0			≥4500	≥1500	≤16	≤55				
	1.5			≥4600	≥1600	≤24	≤85				
	1.75			≥4700	≥1700	≤32	≤100				
	2.5			≥5000	≥2200	≤48	≤140				
1000	1.0	900×2100	1600×1500	2200×2200	≥4500	≥1500	2200×2200	≥2500	≤16	≤55	13
	1.5			≥4600	≥1600	≤24	≤85				
	1.75			≥4700	≥1700	≤32	≤100				
	2.0			≥4800	≥1800	≤40	≤110				
	2.5			≥5000	≥2200	≤48	≤140				
1250	1.0	1000×2100	1800×1600	2400×2350	≥4500	≥1500	2400×2350	≥2500	≤16	≤55	16
	1.5			≥4600	≥1600	≤24	≤85				
	1.75			≥4700	≥1700	≤32	≤100				
	2.0			≥4800	≥1800	≤40	≤110				
	2.5			≥5000	≥2200	≤48	≤140				
1350	1.0	1000×2100	1800×1700	2400×2450	≥4500	≥1500	2400×2450	≥2500	≤16	≤55	18
	1.5			≥4600	≥1600	≤24	≤85				
	1.75			≥4700	≥1700	≤32	≤100				
	2.0			≥4800	≥1800	≤40	≤110				
	2.5			≥5000	≥2200	≤48	≤140				
1600	1.0	1100×2100	2000×1700	2600×2450	≥4500	≥1500	2600×2450	≥2500	≤16	≤55	21
	1.5			≥4600	≥1600	≤24	≤85				
	1.75			≥4700	≥1700	≤32	≤100				
	2.0			≥4800	≥1800	≤40	≤110				
	2.5			≥5000	≥2200	≤48	≤140				
	3.0			2650×2500	≥5500	≥2700	2650×2500		≤56	≤160	

Note: only for reference, final manufacture please follow contract.

MACHINE ROOMLESS PASSENGER ELEVATOR CONSTRUCTION SKETCH

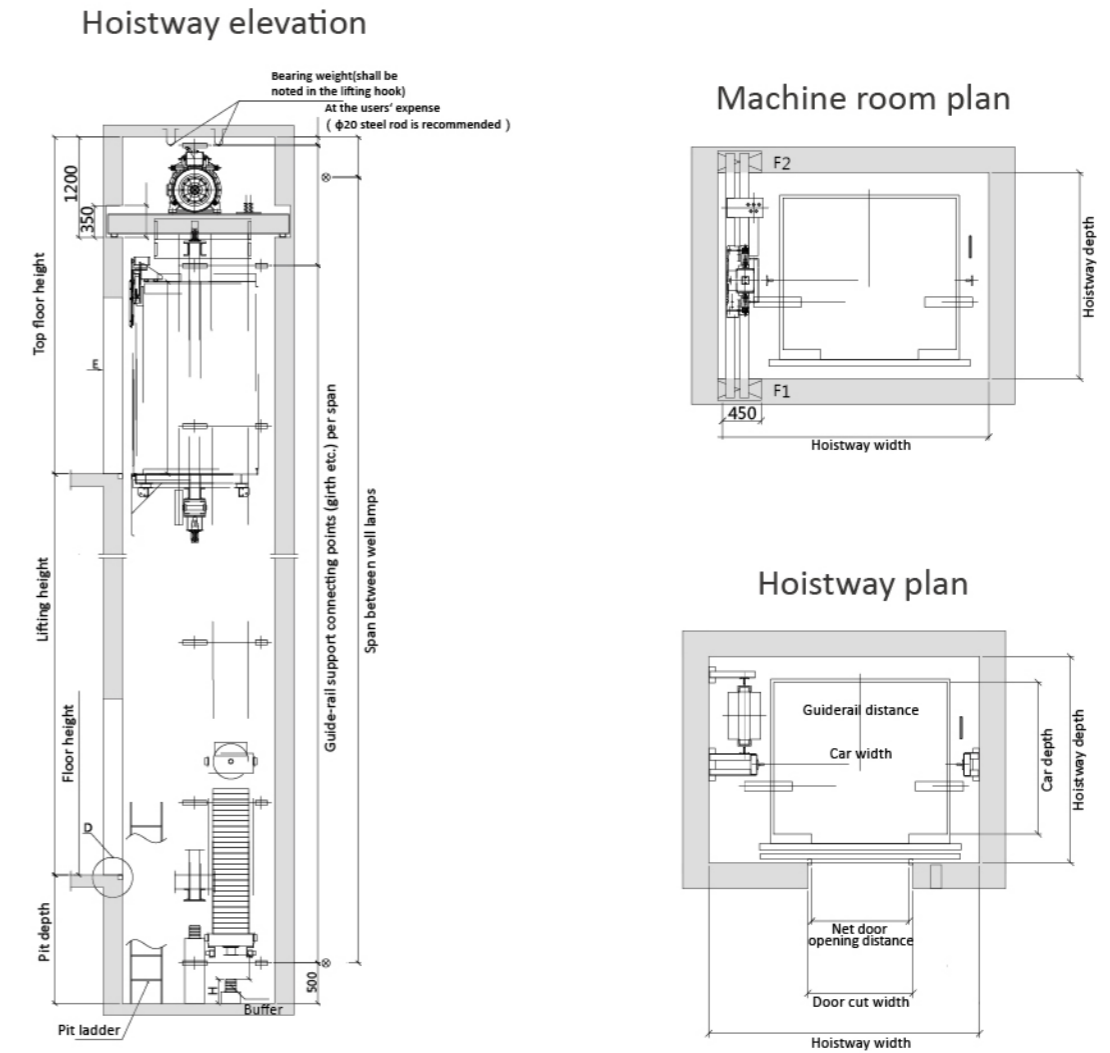

Capacity kg	Speed m/s	Door size DW×DH(mm)	Cabin size CW×CD(mm)	Shaft size HW×HD(mm)	Top floor height OH(mm)	Pit depth PD(mm)	Layer number	Maximum lifting height TH(m)	Person
450	1.0	800×2100	1100×1150	2050×1700	≥4500	≥1550	≤16	≤55	6
	1.5				≥4600	≥1650	≤24	≤85	
	1.75				≥4700	≥1700	≤32	≤100	
630	1.0	800×2100	1100×1400	2100×1900	≥4500	≥1550	≤16	≤55	8
	1.5				≥4600	≥1650	≤24	≤85	
	1.75				≥4700	≥1700	≤32	≤100	
800	1.0	800×2100	1400×1350	2300×1850	≥4500	≥1550	≤16	≤55	10
	1.5				≥4600	≥1650	≤24	≤85	
	1.75				≥4700	≥1700	≤32	≤100	
1000	1.0	900×2100	1600×1500	2500×2000	≥4500	≥1550	≤16	≤55	13
	1.5				≥4600	≥1650	≤24	≤85	
	1.75				≥4700	≥1700	≤32	≤100	
1250	1.0	1000×2100	1600×1800	2600×2400	≥4500	≥1550	≤16	≤55	16
	1.5				≥4600	≥1650	≤24	≤85	
	1.75				≥4700	≥1700	≤32	≤100	
1350	1.0	1000×2100	1600×1900	2700×2400	≥4500	≥1550	≤16	≤55	18
	1.5				≥4600	≥1650	≤24	≤85	
	1.75				≥4700	≥1700	≤32	≤100	
1600	1.0	1000×2100	1800×1900	2800×2400	≥4500	≥1550	≤16	≤55	21
	1.5				≥4600	≥1650	≤24	≤85	
	1.75				≥4700	≥1700	≤32	≤100	

Note: only for reference, final manufacture please follow contract.

OBSERVATION ELEVATOR CONSTRUCTION SKETCH

Hoistway elevation

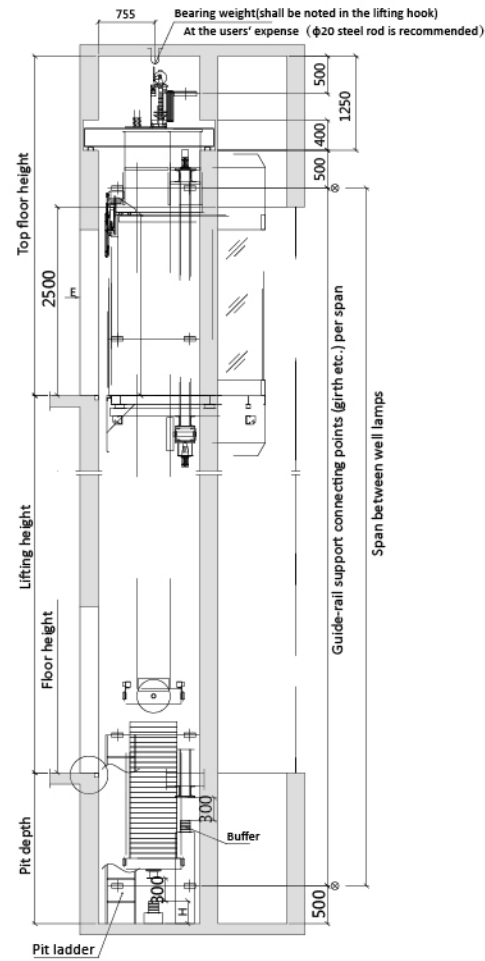

Machine room plan

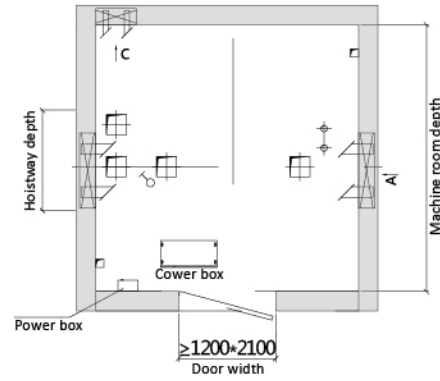

Hoistway plan

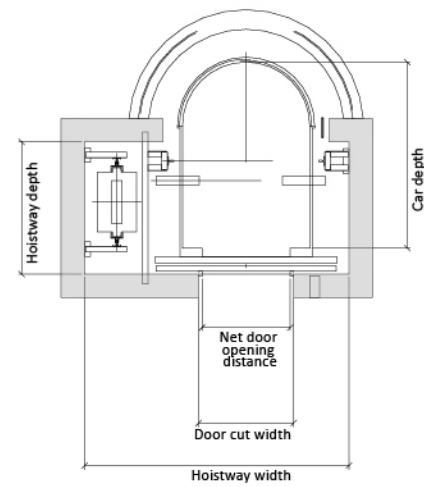

Capacity kg	Speed m/s	Door size DW×DH(mm)	Cabin size CW×CD(mm)	Shaft size HW×HD(mm)	Top floor height OH(mm)	Pit depth PD(mm)	Machine room size RW×RH(mm)	Machine room height RH(mm)	Maximum Layer Station Number	Maximum lifting height TH(m)	Person
800	1.0	800×2100	1200×1700	2300×2700	≥4800	≥1800	2300×2700	≥2500	≤16	≤55	10
	1.5				≥4900	≥1900			≤24	≤85	
	1.75				≥5000	≥2000			≤32	≤100	
1000	1.0	900×2100	1400×1800	2400×2400	≥4800	≥1800	2400×2400	≥2500	≤16	≤55	13
	1.5				≥4900	≥1900			≤24	≤85	
	1.75				≥5000	≥2000			≤32	≤100	
1150	1.0	900×2100	1400×2000	2500×2600	≥4800	≥1800	2500×2600	≥2500	≤16	≤55	15
	1.5				≥4900	≥1900			≤24	≤85	
	1.75				≥5000	≥2000			≤32	≤100	
1250	1.0	1000×2100	1500×2000	2650×2600	≥4800	≥1800	2650×2600	≥2500	≤16	≤55	16
	1.5				≥4900	≥1900			≤24	≤85	
	1.75				≥5000	≥2000			≤32	≤100	
1350	1.0	1000×2100	1500×2100	2650×2700	≥4800	≥1800	2650×2700	≥2500	≤16	≤55	18
	1.5				≥4900	≥1900			≤24	≤85	
	1.75				≥5000	≥2000			≤32	≤100	
1600	1.0	1000×2100	1600×2200	2800×2800	≥4800	≥1800	2800×2800	≥2500	≤16	≤55	21
	1.5				≥4900	≥1900			≤24	≤85	
	1.75				≥5000	≥2000			≤32	≤100	

Note: only for reference, final manufacture please follow contract.

HOSPITAL ELEVATOR CONSTRUCTION SKETCH

Hoistway elevation

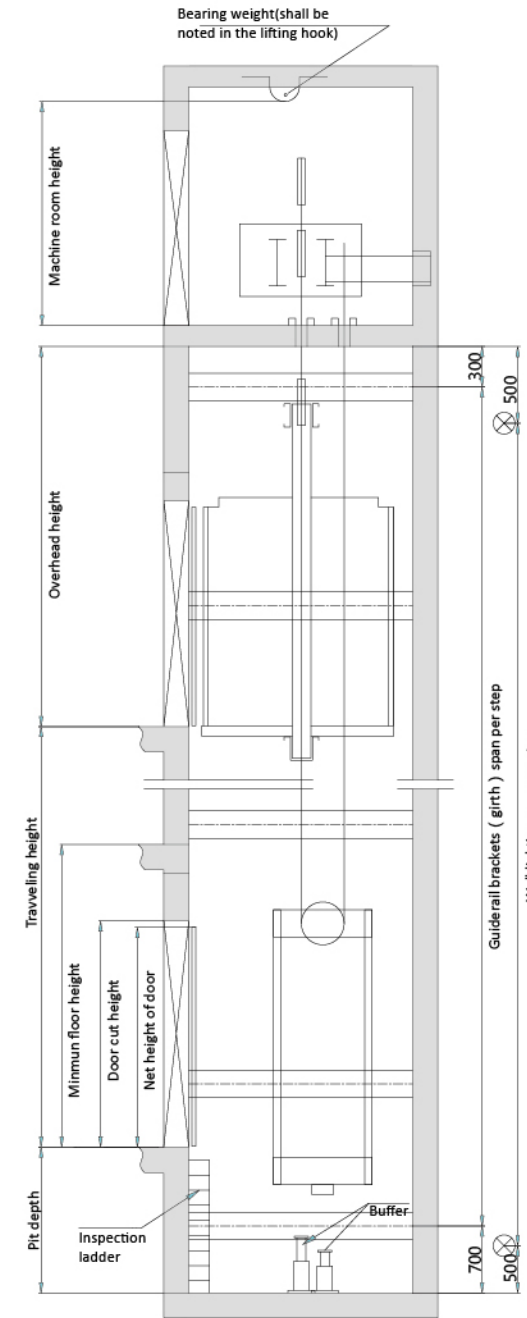

Machine room plan

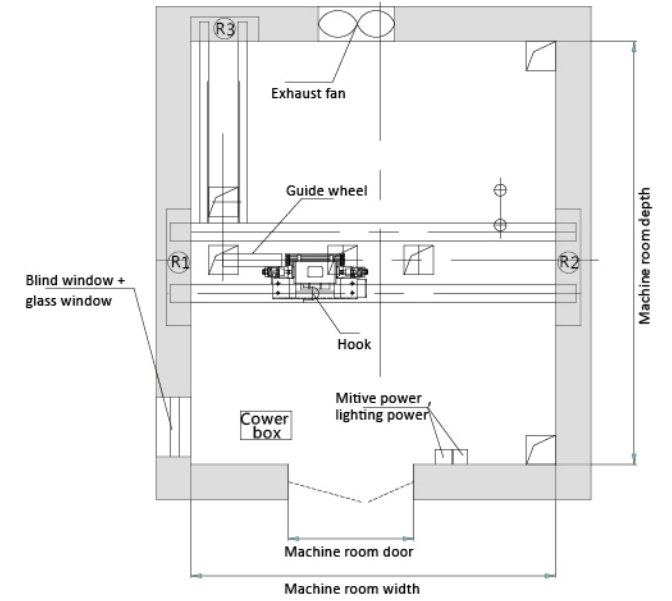

Hoistway plan

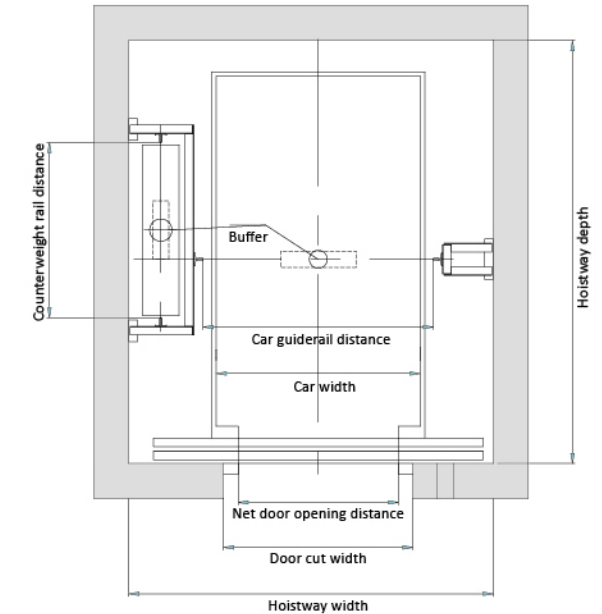

Capacity kg	Speed m/s	Door size DW×DH(mm)	Cabin size CW×CD(mm)	Shaft size HW×HD(mm)	Top floor height OH(mm)	Pit depth PD(mm)	Layer number	Maximum lifting height TH(m)	Person
1600	1.0	1100×2100	1400×2400	2500×2900	≥4500	≥1500	≤16	≤55	21
	1.5				≥4600	≥1600	≤24	≤85	
	1.75				≥4700	≥1700	≤32	≤100	
	2.0				≥4800	≥1800	≤40	≤110	

Note: only for reference, final manufacture please follow contract.

VILLA ELEVATOR CONSTRUCTION SKETCH

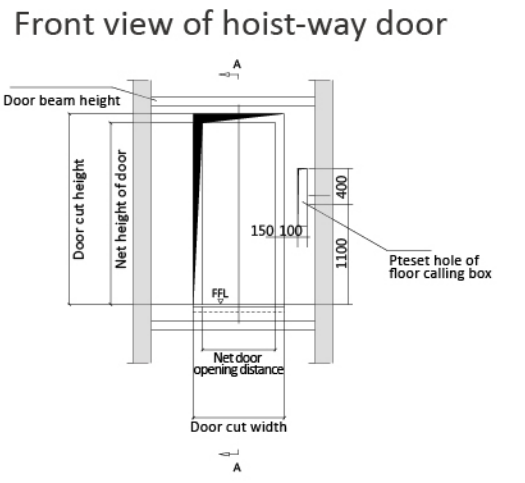
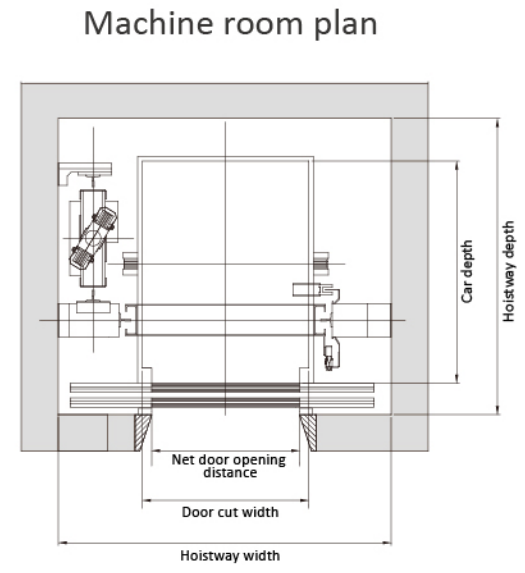
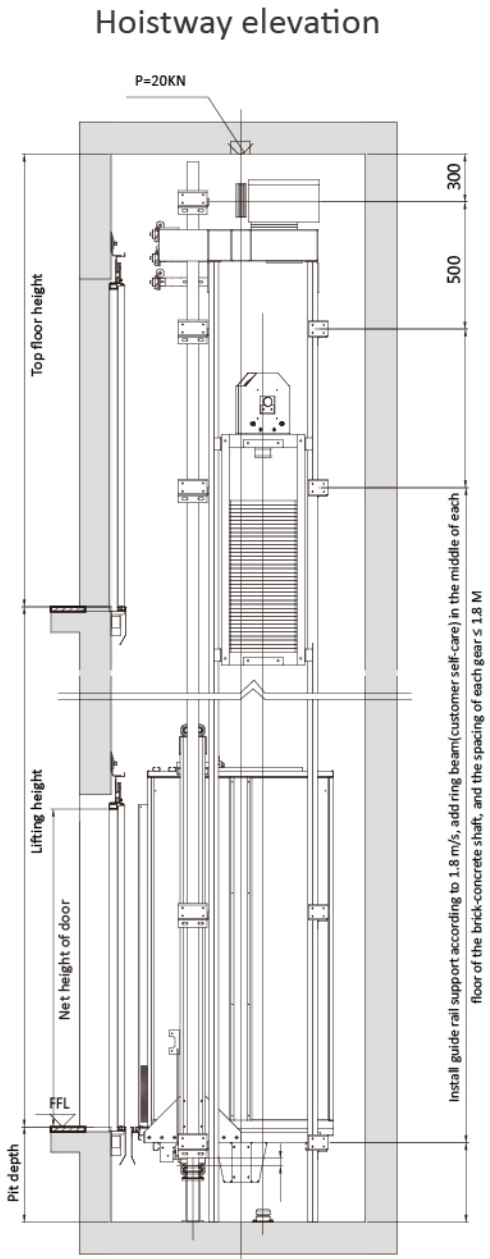

Capacity kg	Speed m/s	Door size DW× DH(mm)	Cabin size CW× CD(mm)	Shaft size HW× HD(mm)	Top floor height OH(mm)	Pit depth PD(mm)	Layer number	Maximum lifting height TH(m)	Person
250	0.4	700×2000	900×1200	1600×1600	≥3500	≥500	≤5	≤12	3
320		700×2000	1000×1200	1700×1600					4
400		800×2000	1100×1200	1800×1600					5

Note: only for reference, final manufacture please follow contract.

FREIGHT ELEVATOR CONSTRUCTION SKETCH

Elevation view of well right-side

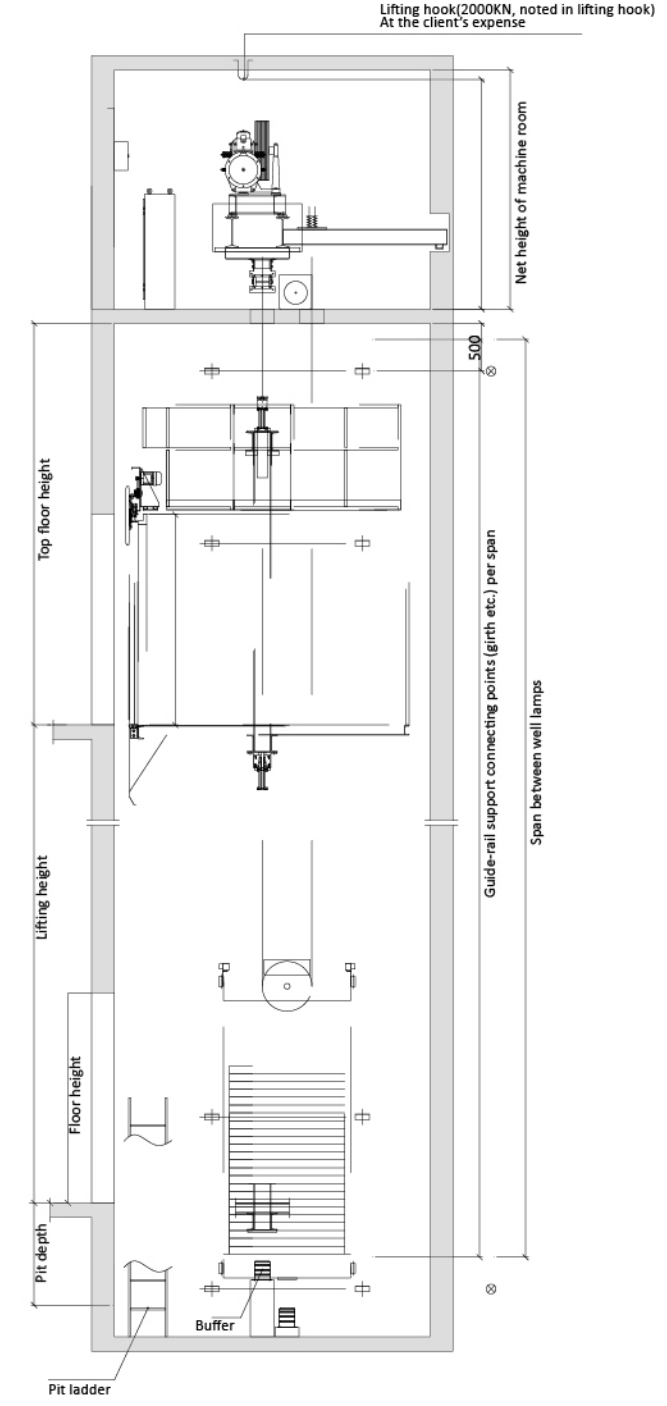

Machine room layout chart

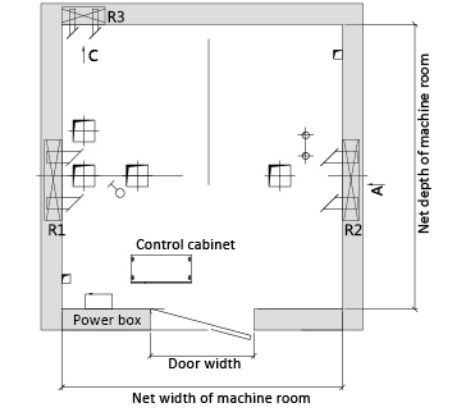

Pit plan

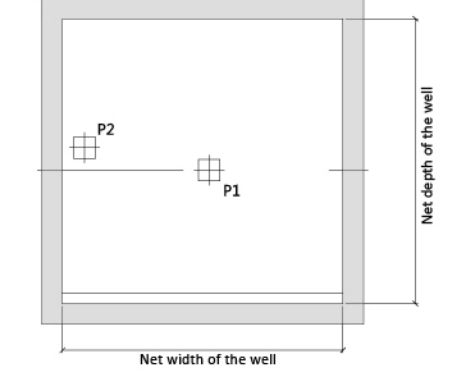

Hoistway plan

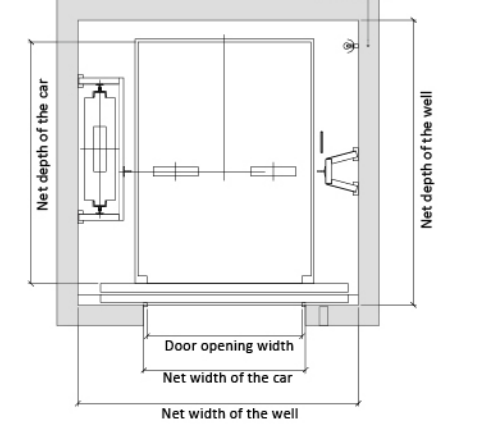

Capacity kg	Speed m/s	Door size DW× DH(mm)	Cabin size CW× CD(mm)	Shaft size HW× HD(mm)	Top floor height OH(mm)	Pit depth PD(mm)	Machine room size RW× RH(mm)	Power
1000	0.5	1200x2100	1400x1700	2300x2200	4500	1500	2300x2200	7.5
	1.0							
1600	0.5	1400x2100	1700x2000	2600x2500	4500	1500	2600x2500	11
	1.0							
2000	0.5	1500x2100	2000x2100	2900x2600	4500	1500	2900x2600	11
	1.0							
3000	0.5	1800x2100	2000x2900	3250x3400	4500	1500	3250x3400	15
	1.0							
4000	0.5	2200x2400	2200x3300	3800x3800	5000	1600	3800x3800	18.5
5000	0.5	2200x2400	2500x3500	4200x4000	5000	1600	4200x4000	22

Note: only for reference, final manufacture please follow contract.

AUTOMOBILE ELEVATOR CONSTRUCTION SKETCH

Elevation view of well right-side

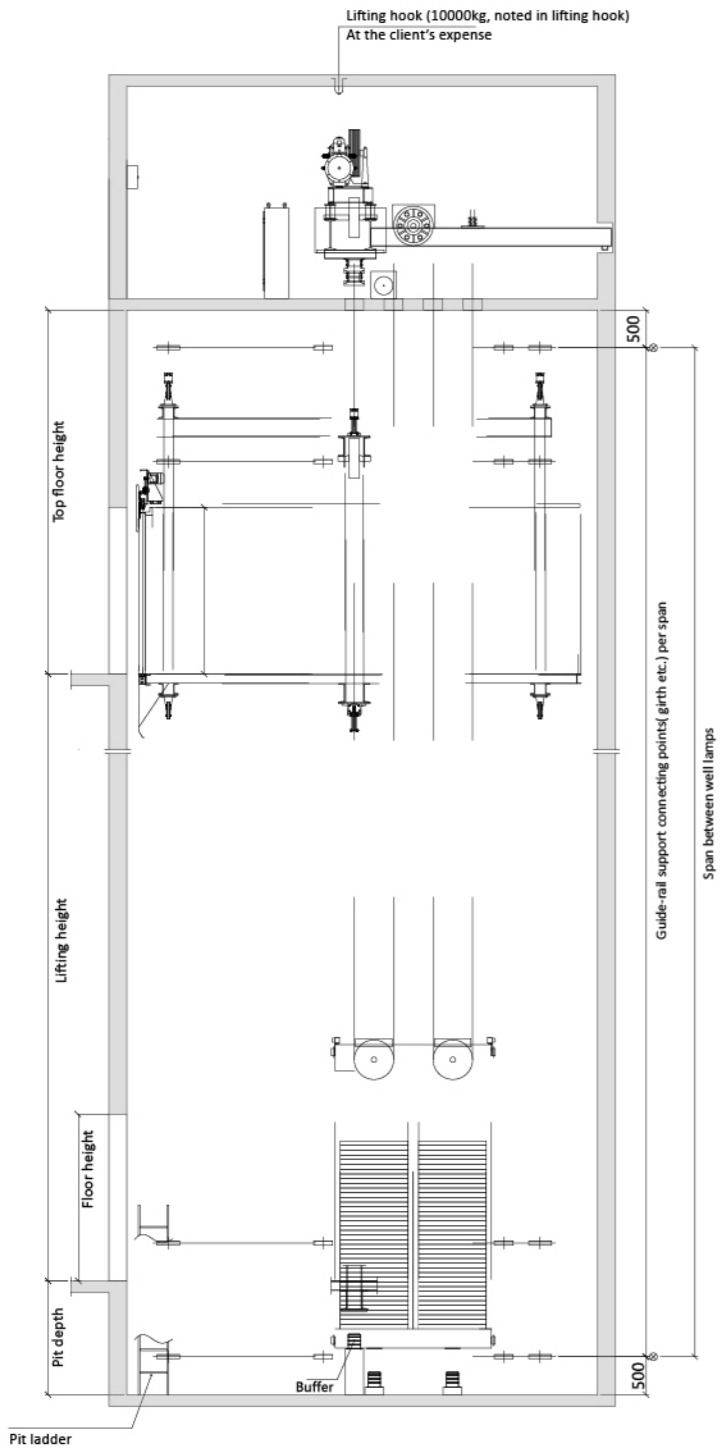

Machine room layout chart

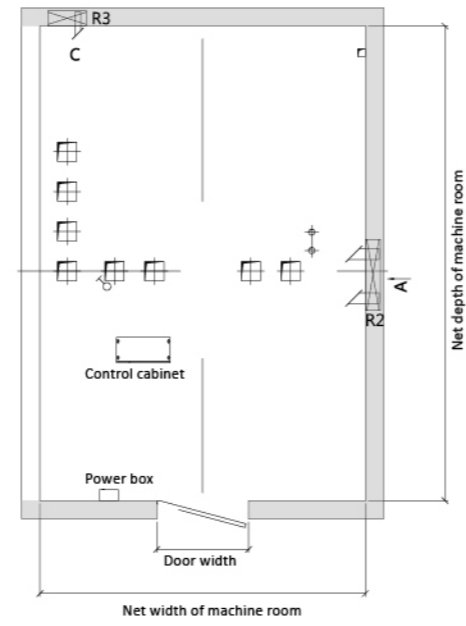

Hoistway plan

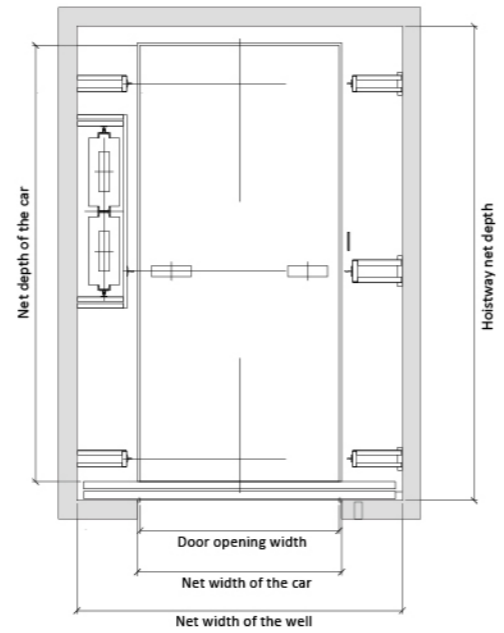

DUMBWAITER ELEVATOR CONSTRUCTION SKETCH

Hoistway plan(ground type)

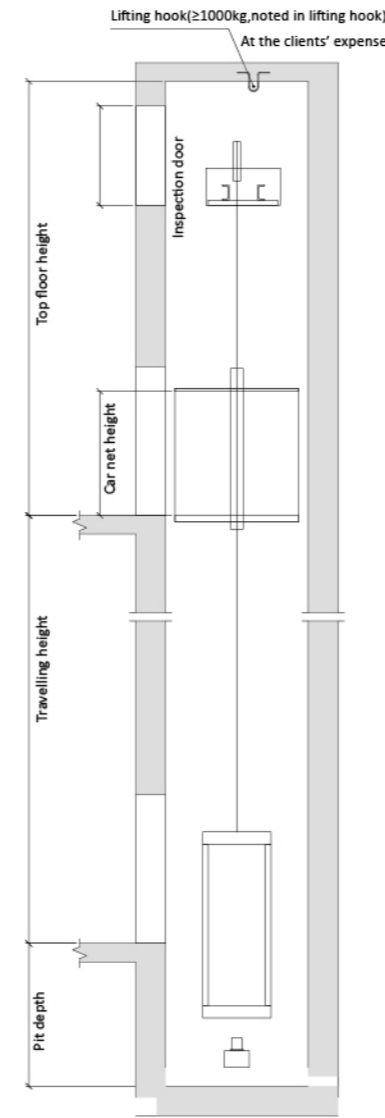

Hoistway plan(window type)

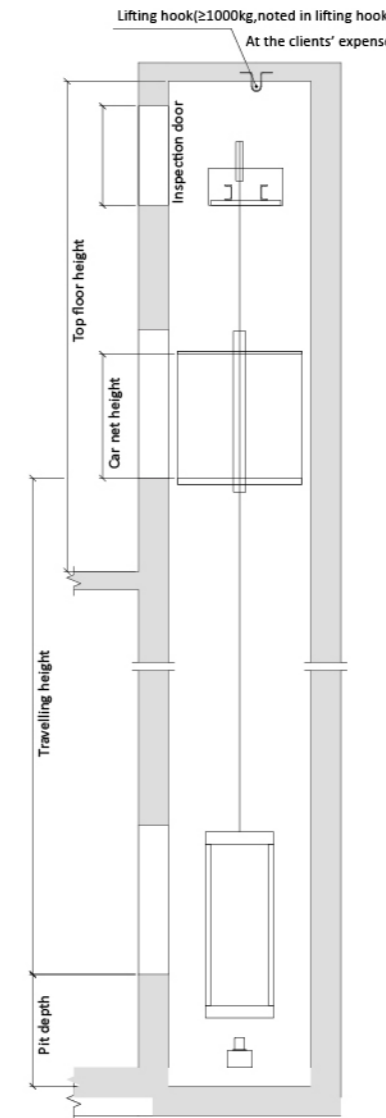

Top floor plan

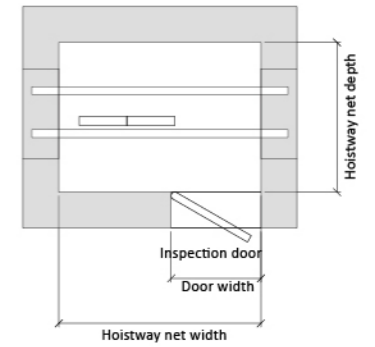

Hoistway plan

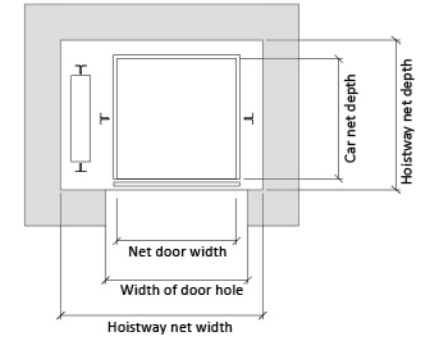

Capacity kg	Speed m/s	Door size DW× DH(mm)	Cabin size CW× CD(mm)	Shaft size HW× HD(mm)	Top floor height OH(mm)	Pit depth PD(mm)	Machine room size RW× RH(mm)	Power
3000	0.5	2600×2400	2600×5700	4250×6200	≥5000	≥1600	4250×6200	15
5000	0.5	2700×2400	3400×7200	4850×7700			4850×7700	22

Note: only for reference, final manufacture please follow contract.

Loading capacity		100	200	200	250
Speed		0.4	0.4	0.4	0.4
Car net size	Width	700	950	950	1000
	Depth	700	950	950	1000
Door-opening type		Up/down center opening type			
Door-opening size	width	700	950	950	1000
	Height	1000	1000	1000	1000
Hoistway net size	width	1350	1600	1600	1650
	Height	1000	1250	1250	1300
Top floor height		3800	3800	3800	3800
Pit depth		1000	1000	1000	1000
Max travelling height		20	20	20	20
Work type		Window type	Window type	Fall to the ground type	Fall to the ground type

Note: only for reference, final manufacture please follow contract.

Construction Sketch 30° /1000 Escalator

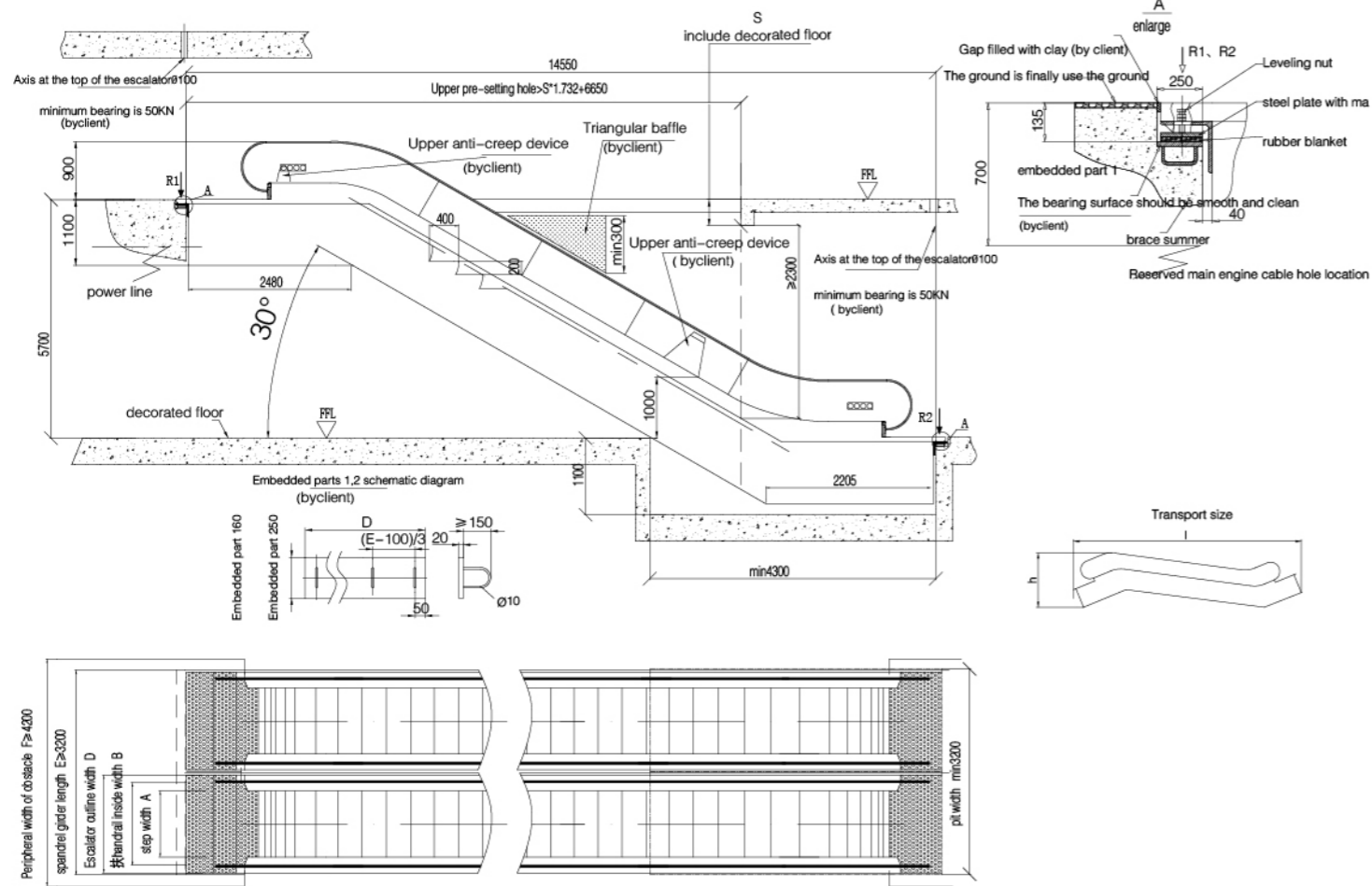

30° Escalator specifications

Model	Travelling height(mm)	Rated speed (m/s)	Capacity per./h	Inclination (°)	No. of horizontal steps	Motor power (Kw)	A (mm)	B (mm)	C (mm)	D (mm)
SA (600/30°)	3000 ≤ H ≤ 6000	0.5	3600	30	2(3)	8	600	838	1200	≥1260
	6000 < H ≤ 7200				3	11				
SA (800/30°)	3000 ≤ H ≤ 4800	0.5	4800	30	2(3)	8	800	1038	1400	≥1460
	4800 < H ≤ 6000				2(3)	11				
	6000 < H ≤ 6400				3	11				
	6400 < H ≤ 7200				3	15				
SA (1000/30°)	3000 ≤ H ≤ 4800	0.5	6000	30	2(3)	8	1000	1238	1600	≥1660
	4800 < H ≤ 6000				2(3)	11				
	6000 < H ≤ 6400				3	11				
	6400 < H ≤ 7200				3	15				
	7200 < H ≤ 8000				3	15				
	8000 < H ≤ 12000				3	2 x 11				

Note: Only for reference, final manufacture please follow contract.

Construction Sketch 30° /1000 Escalator

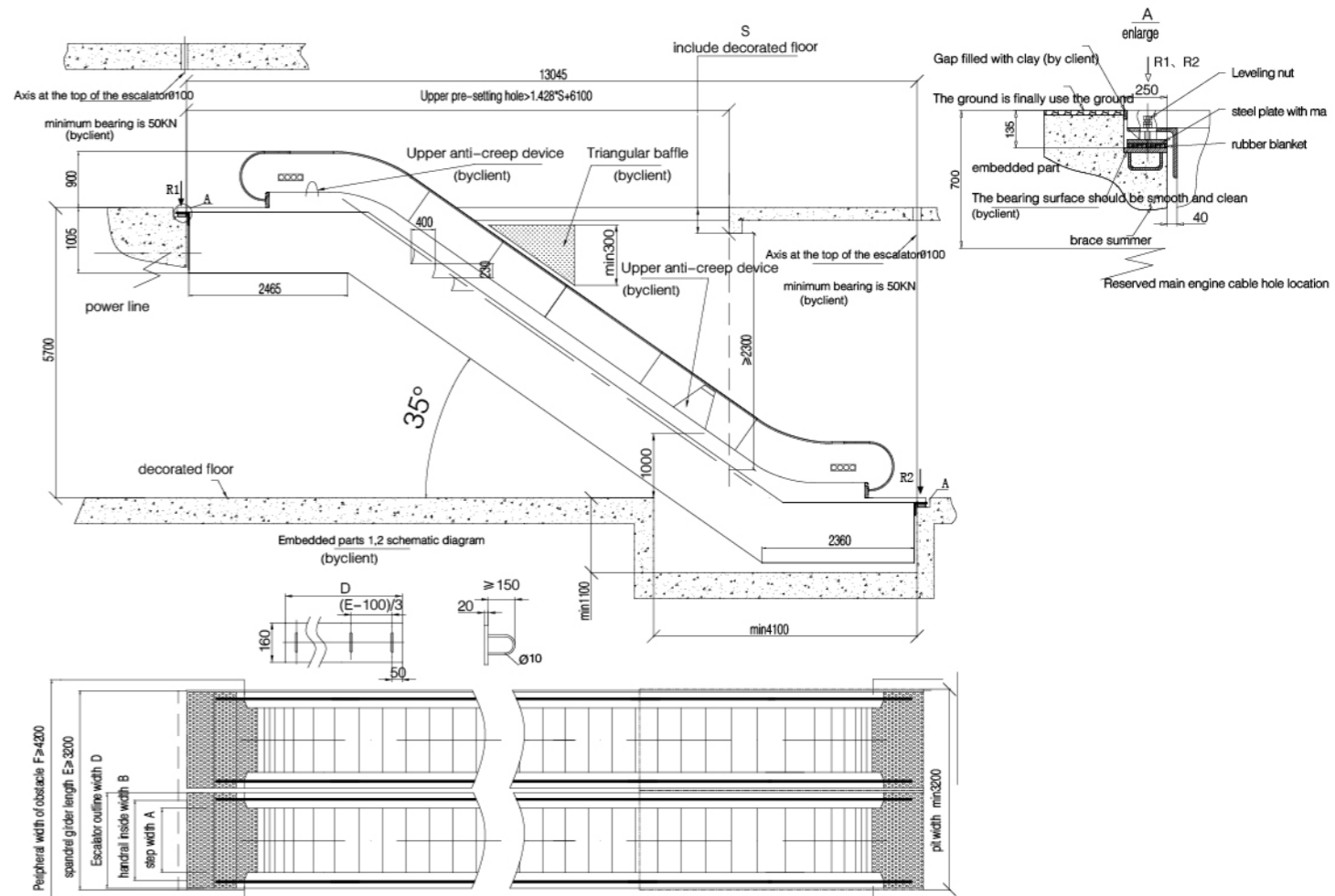

35° Escalator specifications

Model	Travelling height(mm)	Rated speed (m/s)	Capacity (per./h)	Inclination (°)	No. of horizontal steps	Motor power (Kw)	A (mm)	B (mm)	C (mm)	D (mm)
SA (600/35°)	3000 ≤ H ≤ 6000	0.5	3600	35	2	8	600	838	1200	≥1260
SA (800/35°)	3000 ≤ H ≤ 5200	0.5	4800	35	2	8	800	1038	1400	≥1460
	5200 < H ≤ 6000					11				
SA (1000/35°)	3000 ≤ H ≤ 5200	0.5	6000	35	2	8	1000	1238	1600	≥1660
	5200 < H ≤ 6000					11				

Note: Only for reference, final manufacture please follow contract.

Construction Sketch 10°、11°、12° /1000 Mociing walk

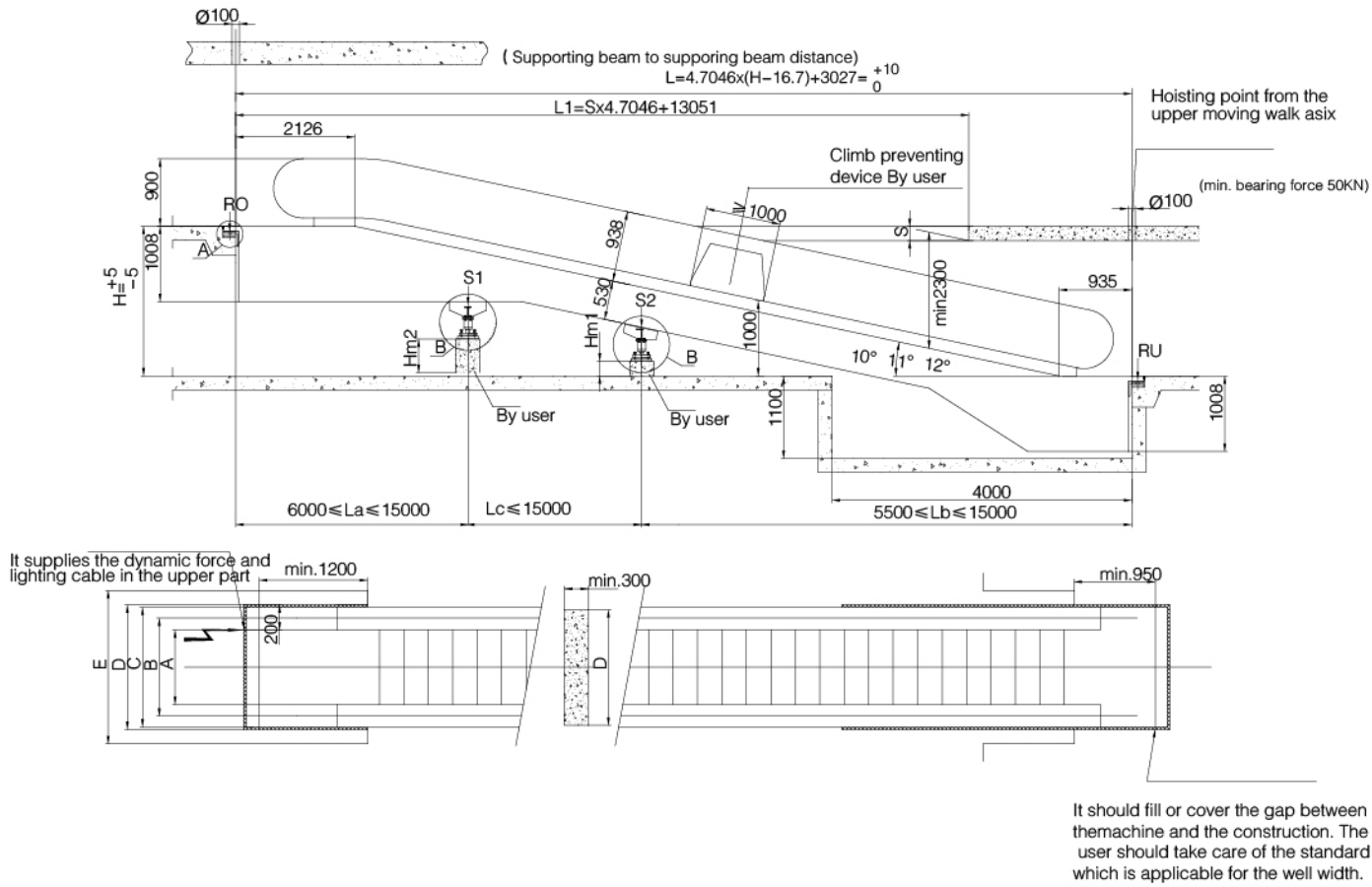

Points For Attention in the construction and installation

Besides complying with the drawing of the contract, attention should also be drawn to the following

- To ensure the safety of the escalator and moving walk, free space should also be large enough in the landing area. (See the minimum size right)
- C=handrail belt width

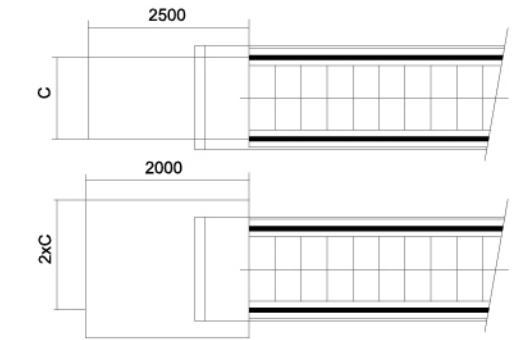

Vertical safety distance

- There should be at least 2.3m upside safety distance starting upward from the step board.
- Notice: if the vertical rise of one escalator, which is installed above another one, is less than 3.3m, the upside safety distance can not reach 2.3m.

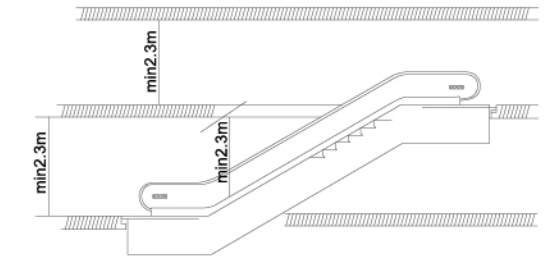

10° -12° Moving walk specifications

Model	Travelling height(mm)	Rated speed (m/s)	Capacity (per./h)	Inclination (°)	Motor power (Kw)	A (mm)	B (mm)	C (mm)	D (mm)
SA (800/10°)	2000 ≤ H ≤ 4200	0.5	6750	10	8	800	1038	1400	≥1460
	4200 < H ≤ 5900				11				
	5900 < H ≤ 6500				15				
SA (1000/10°)	2000 ≤ H ≤ 3300	0.5	9000	10	8	1000	1238	1600	≥1660
	3300 < H ≤ 4600				11				
	4600 < H ≤ 6500				15				
SA (800/11°)	2000 ≤ H ≤ 4300	0.5	6750	11	8	800	1038	1400	≥1460
	4300 < H ≤ 6000				11				
	6000 < H ≤ 6500				15				
SA (1000/11°)	2000 ≤ H ≤ 3400	0.5	9000	11	8	1000	1238	1600	≥1660
	3400 < H ≤ 4700				11				
	4700 < H ≤ 6400				15				
SA (800/12°)	2000 ≤ H ≤ 4500	0.5	6750	12	8	800	1038	1400	≥1460
	4500 < H ≤ 6200				11				
	6200 < H ≤ 6500				15				
SA (1000/12°)	2000 ≤ H ≤ 3500	0.5	9000	12	8	1000	1238	1600	≥1660
	3500 < H ≤ 4900				11				
	4900 < H ≤ 6500				15				

Note: Only for reference, final manufacture please follow contract.

Escalators and moving walk horizontal safety distance

- The horizontal distance between the handrail edge and the wall or other objects should be more than 80mm.
- The vertical distance above the step board should be more than 2.3m.
- The vertical distance above the handrail space should be more than 2.1m.
- In case of floor spaces or the cross layout of escalators and moving walk, the safety distance between the handrail center and the object should be more than 0.5m.
- If the above-mentioned requirements cannot be met, a special protection device and a bumper rail should be used.
- For further information, please contact Suzhou Xinfuji elevator.

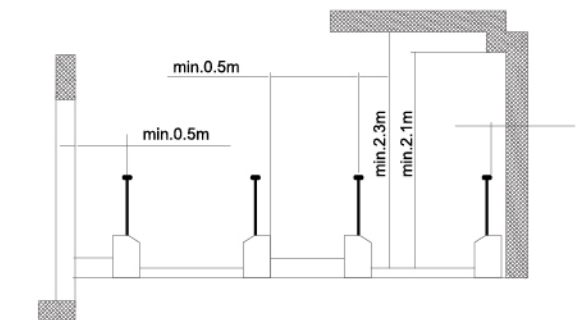

SERVICE SYSTEM

The professional service teams

Suzhou Xinfuji Electromechanical Co., Ltd. offers a dedicated, professional service team to ensure smooth passenger flow 24/7. Our skilled technicians prioritize safety and efficiency, responding promptly to any service needs. We are committed to providing comprehensive, long-term solutions tailored to meet your specific requirements.



Service team

All maintenance service personnel are received strict on-the-job training to execute standard maintenance procedures and provide perfect service experience for customers by depending on strong technical supporting network as well as management system.



Spare parts

All supplied spare parts are conducted strict test before delivery, which includes escalator' s components of various models; distribution network has covered lots of cities all over the country for rapid supply and timely replacement.



Maintenance update

The daily maintenance and upgrading service of high quality elevators provide a good foundation for the efficient operation of the building, and save the customer's elevator maintenance cost.



Remote monitoring system

Achieve informatization management of operations such as 24-hour remote elevator monitoring, timely alarm along with rescue and maintenance, inspection etc so as to guarantee elevator' s safe operation and carry out more convenient and efficient elevator management.

